



T10-6

Term Tech Copper Tube Terminal 10mm² Cable 6mm Hole (Unit 100)



The Termination Technology range of standard copper tube terminals is manufactured from seamless copper tube to BS2871/C106. All terminals are provided with an inspection hole to ensure the conductor is fully inserted before crimping. A bell mouth also ensures a smooth transition from lug to cable, thus avoiding the problems of chafing where the component is subject to vibration. Narrow Palm, Right Angled, Long Palm and more specialist ranges also available.

Technical Data

Colour and Material

| | |
|------------------|--------|
| Material | Copper |
| Plating Material | Tin |

Application Type, Size and Range

| | |
|-------------------------------|----|
| Cable Size (mm ²) | 10 |
|-------------------------------|----|

Dimensions

| | |
|------------------|-----|
| Dimension D (mm) | 4.4 |
| Dimension L (mm) | 26 |
| Dimension W (mm) | 11 |
| Fixing Hole (mm) | 6 |

Product Specification

| | |
|---------------|---|
| Specification | BS EN 61238-1 2003, IEC 61238-2003, BS2781/C106 |
|---------------|---|

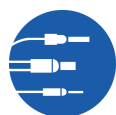

**Termination
Technology Ltd**
Quality and Service

The company with the RIGHT connections at the RIGHT price.

Company Registration Number: 05062297

W: www.termtech.co.uk

T: 01179 354 900

E: sales@termtech.co.uk

Termination Technology Ltd, Unit 4C Crofts End Ind Estate, Crofts End Road,
Bristol BS5 7UW



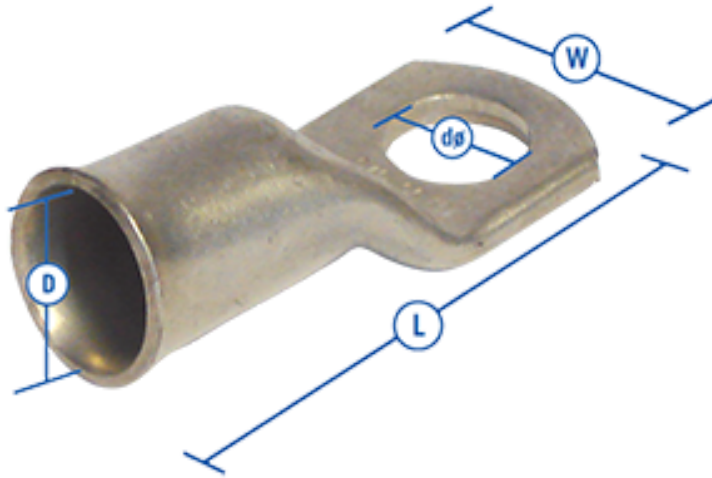

**Termination
Technology Ltd**

Quality and Service

The company with the **RIGHT** connections at the **RIGHT** price.

Company Registration Number: 05062297

W: www.termtech.co.uk

T: 01179 354 900

E: sales@termtech.co.uk

Termination Technology Ltd, Unit 4C Crofts End Ind Estate, Crofts End Road,
Bristol BS5 7UW

